

Detail to glaze a door

PAGE 1 of 2

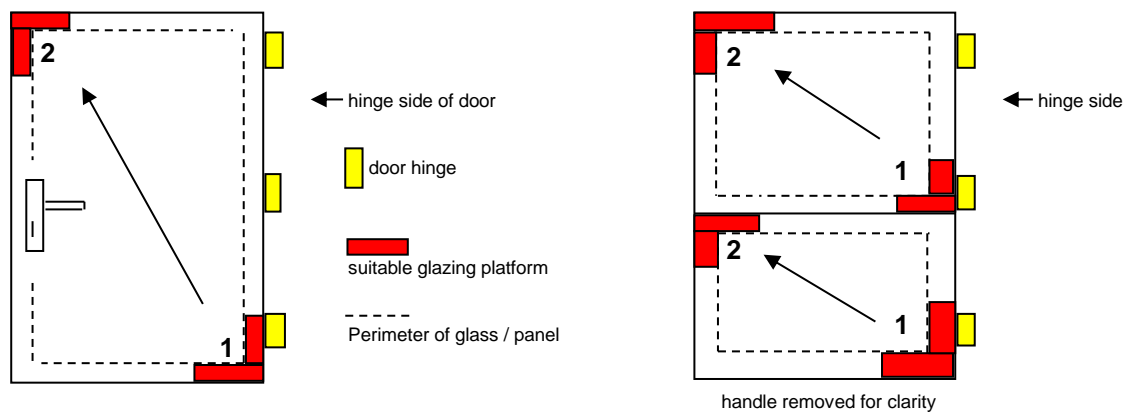

PACK BOTTOM HINGE SIDE AS SHOWN

PLACE PANEL / GLASS ONTO PACKERS (1)

USING A GLAZING SHOVEL BETWEEN PANEL / GLASS & SASH

RAISE SASH TO REQUIRED POSITION AND INSERT THE CORRECT

AMOUNT OF PACKERS AT THE TOP OF THE LOCK SIDE (2) TO BRACE INTO POSITION.

ENSURE THAT PACKERS ARE SEATED FULL WIDTH OF GLASS / PANEL TO SUPPORT GLASS / SKINS AND NOT DIGGING INTO SEALANT / FOAM AS THIS WILL CAUSE THE PRODUCT TO FAIL & INVALIDATE ANY GUARANTEE.

Care & Maintenance of UPVC Products

Clean products with mild soap & warm water only. Stubborn stains can be removed with careful use of specialist upvc cream cleaner or solvent cleaner, always follow the instructions on the product, and must only be applied to white profile and never be applied to a foiled or sprayed surface. Moving parts are to be lubricated periodically to maintain smoothness of operation, the use of light machine oil is recommended. Period of maintenance is dependant upon global positioning and climate conditions. Glass cleaner is available from our shop as is specialist glass cleaners for self cleaning glasses. Take the advice of a professional if in any doubt.

Adjustments

The product will not require adjustment once installed correctly. In the event of minor adjustments to be made follow the guide below.

Door Hinges due to product development- hinges may vary.

DO NOT ADJUST HINGES UNLESS GLAZED CORRECTLY- KNOWN AS TOE & HEALED

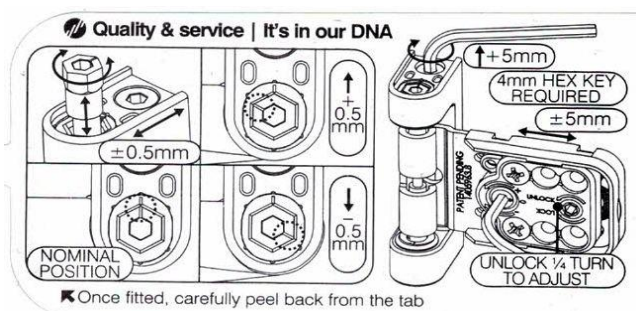

the door sash can be lifted off hinge brackets when the door is in the open position if required. to refit- slide the door hinges onto the frame brackets care must be taken to carry out his procedure as the door sash can be heavy. Only carry this out if you are competent in doing so. remove any restrictors before carrying this out.

Drawing correct as of January 2019

Door Locks due to product development- locks may vary.

Latch adjustment is carried out by slackening the two screws retaining the latch keep using a pozi 2 driver*. move the latch to the required position before retightening.

Compression adjustment is carried out by inserting a Allen key directly into the end of the roller cam and rotating to the desired setting. Remember there are various cams along the locking mechanism.

*sometimes the adjustments may be hex key (allen key), torx, phillips or pozi.

THIS SHEET IS INTENDED AS A GENERAL GUIDELINE. IF YOU ARE UNSURE ABOUT ANY OF THE PROCEDURES CONSIDER EMPLOYING A PROFESSIONAL WHO IS COMPETENT IN FRAME & GLASS INSTALLATION

Cream Cleaner ; Solvent Cleaner ; Glass Cleaner ; Glazing Packers ; Glazing Shovels
as well as fixings, foam, silicone, screws, drill bits, saws, dust sheets etc
can be purchased from West Lancs Trade Plastics trade shop located on Platts Lane, Burscough
TEL. 01704 893335 www.westlancstradeplastics.co.uk

Detail to glaze a window

PAGE 2 of 2

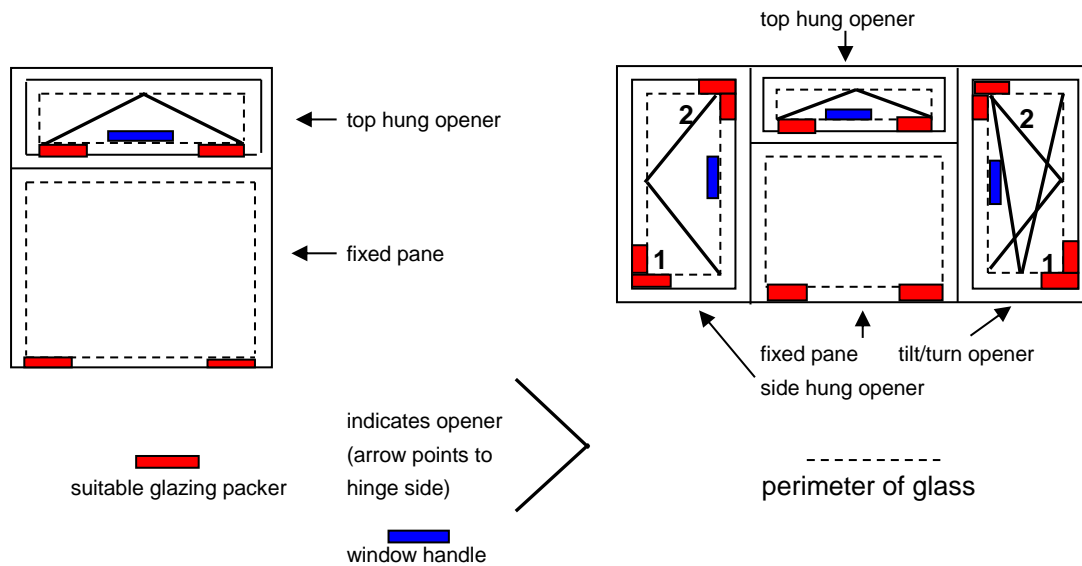

Top hung & fixed panes

Using suitable glazing packers, pack at bottom horizontally as shown to avoid movement & maintain correct spacings.

Side hung and tilt/turn windows (same procedure as a door)

Using suitable glazing packers pack horizontally & vertically as shown in position 1.

Place glass onto packers

Using a glazing shovel between glass and top of sash raise sash to required position and insert packers in position 2 until braced into required position.

Ensure that the glazing packers are seated onto the unit correctly and are supporting both panes of glass and not digging into the sealant, as this will cause the unit to fail & invalidate any guarantee offered.

Care & Maintenance of UPVC Products

Clean products with mild soap & warm water only. Stubborn stains can be removed with careful use of specialist upvc cream cleaner or solvent cleaner, always follow the instructions on the product, and must only be applied to white profile and never be applied to a foiled surface of profile.

moving parts are to be lubricated periodically to maintain smoothness of operation and help prevent corrosion, the use of light machine oil is recommended. Period of maintenance is dependant upon global positioning and climate conditions.

Glass cleaner is available from our shop as is specialist glass cleaners for self cleaning glasses.

specialist cleaners are available from our shop for foiled products and composite doors

Adjustments

The product will not require adjustment once installed correctly. In the event of minor adjustments to be made follow the guide below.

Friction Stays

To adjust friction slide control, tighten / loosen the friction adjuster screw, (this is a brass slotted screw located on the black plastic slider attached to the friction stay on the frame side.)

The sash (opener) can be adjusted if need be, by slackening the friction stay screws and aligning the sash.

Retighten screws, this procedure is best done with the sash unglazed to minimise weight.

Espag Rod / Shootbolt cams.

To adjust compression on the sash to frame seal insert Allen key* into the end of the cam (with the sash open) and rotate until desired compression is achieved, remember there are various cams along the length

THIS SHEET IS INTENDED AS A GENERAL GUIDELINE. IF YOU ARE UNSURE ABOUT ANY OF THE PROCEDURES CONSIDER EMPLOYING A PROFESSIONAL WHO IS COMPETENT IN FRAME & GLASS INSTALLATION

Cream Cleaner ; Solvent Cleaner ; Glass Cleaner ; Glazing Packers ; Glazing Shovels
as well as fixings, foam, silicone, screws, drill bits, saws, dust sheets etc
can be purchased from West Lancs Trade Plastics trade shop located on Platts Lane, Burscough
TEL. 01704 893335 www.westlancstradeplastics.co.uk