

Toe and Heeling Adjusting Tool

The adjusting tool is designed to help adjust doors after beading

STEP 1

Pack bottom corner with 2 x 4mm bridge packers and 2 x 5mm glazing packers - See Toe & Heeling Guide for placement

STEP 2

Place 2 x 4mm bridge packers to the head of the prepped corner-use silicone to hold in place

STEP 3

Insert glass unit
Insert plastic corner and steel cover-
MUST BE FITTED

STEP 4

Wind Adjusting Screw into Block with 4mm allen key - tighten to adjust door height. Introduce further packers if required between corner packer and glass

STEP 5

Tap beads in when alignment is complete



Toe and Heeling Tools

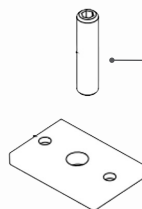
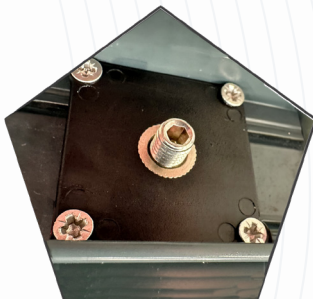

Adjusting Screw
4mm Allen Key

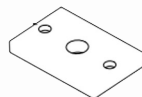

Adjusting Block
(fixed to head of sash
in factory)

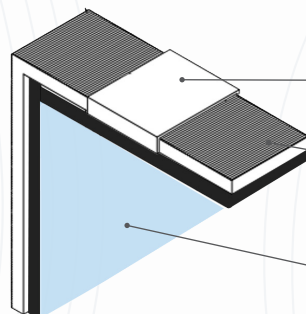

Steel Cover
MUST BE FITTED

Plastic Corner
Packer

Glass

Installing the Doors

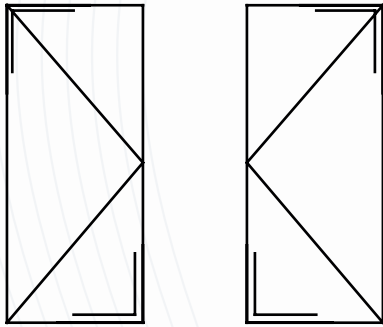

D. Glazing and Toe & Heeling

Where shown indicates area to pack

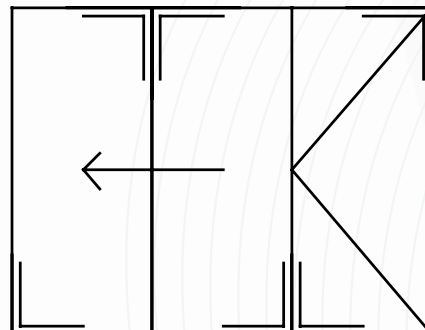
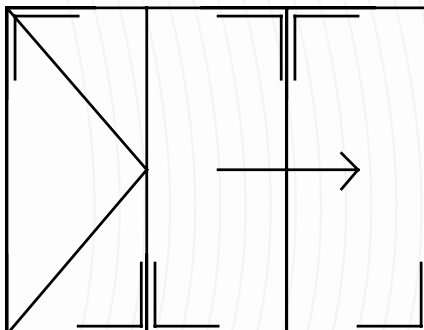
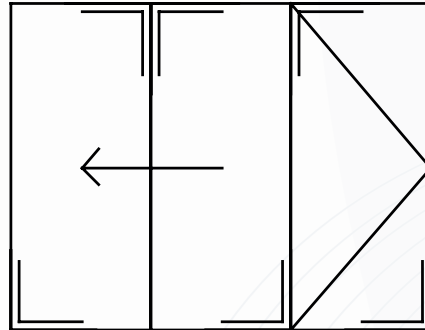
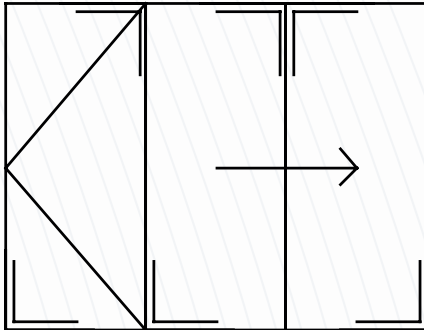
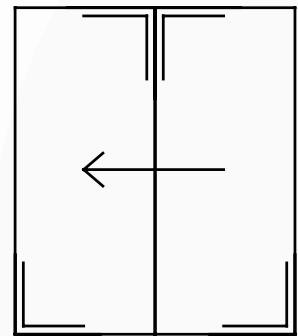
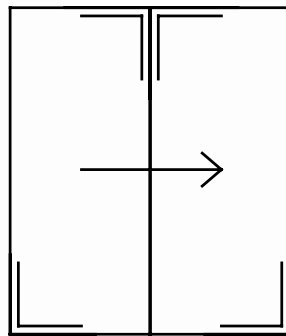
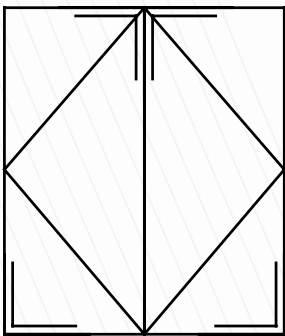

Installing the Doors

D. Glazing and Toe & Heeling

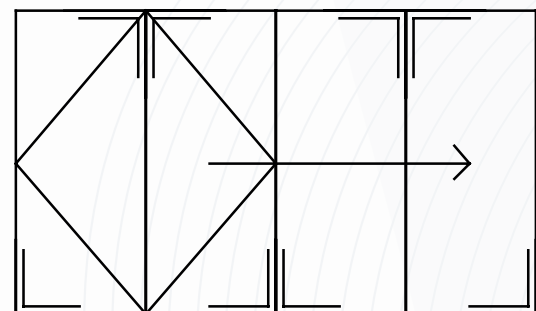
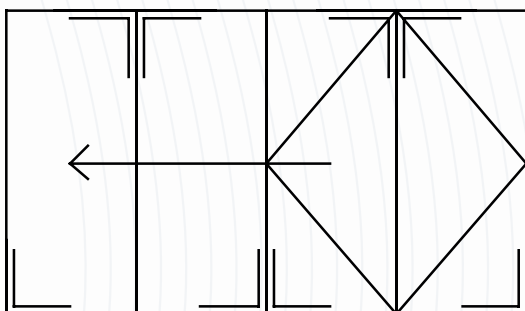
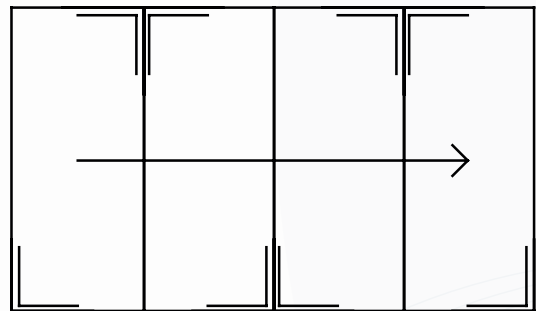
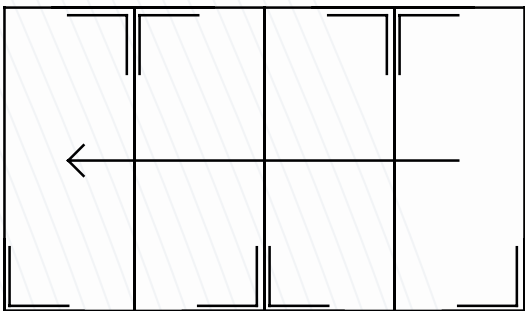
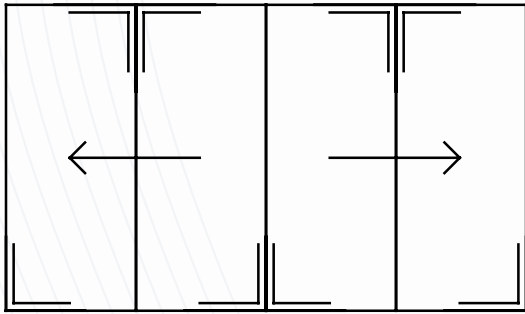

Installing the Doors

D. Glazing and Toe & Heeling

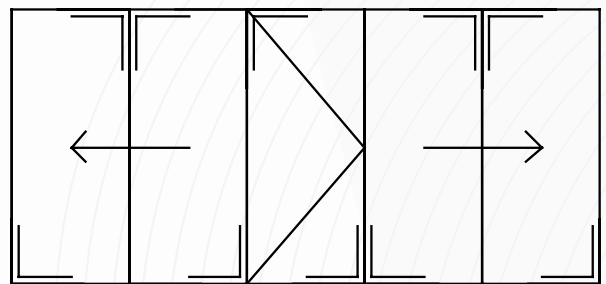
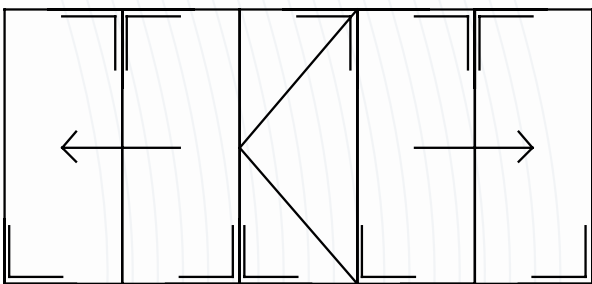
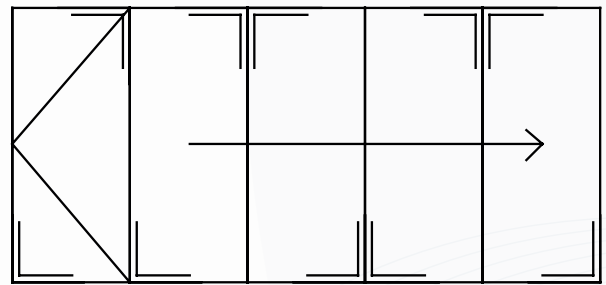
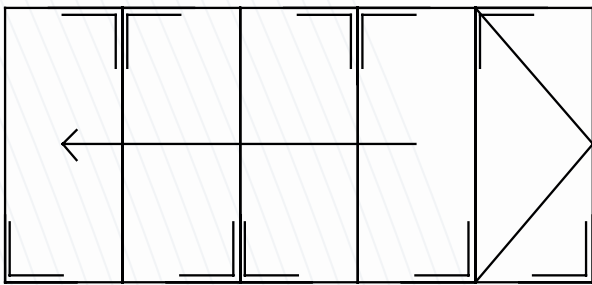
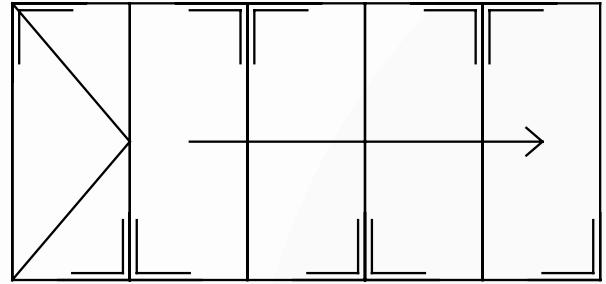
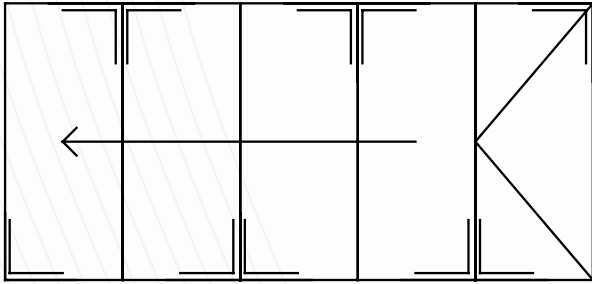

Installing the Doors

D. Glazing and Toe & Heeling

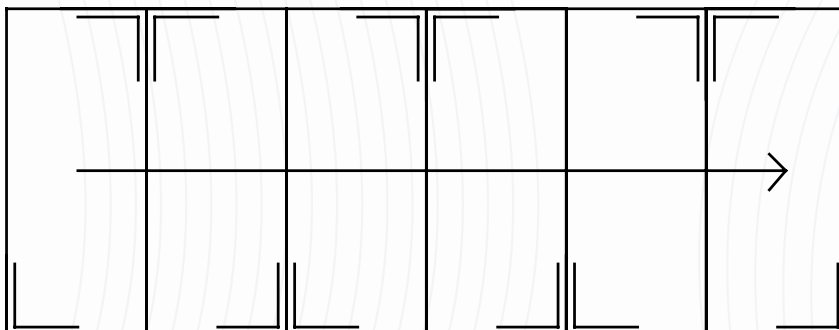
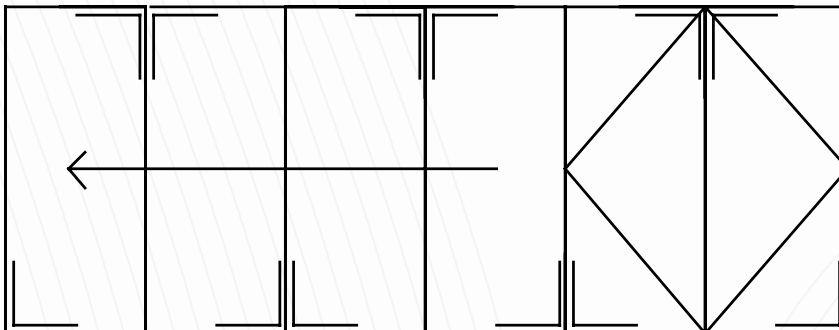
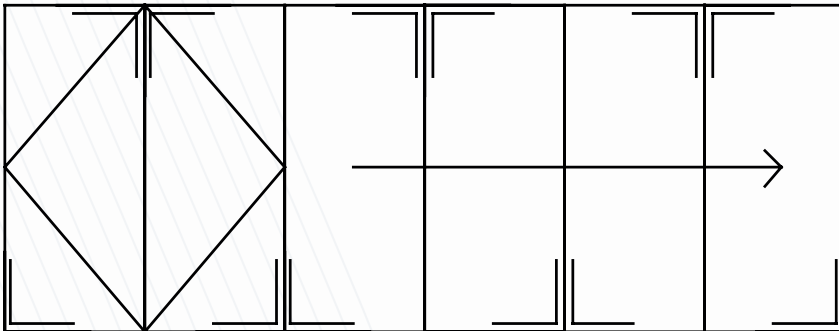
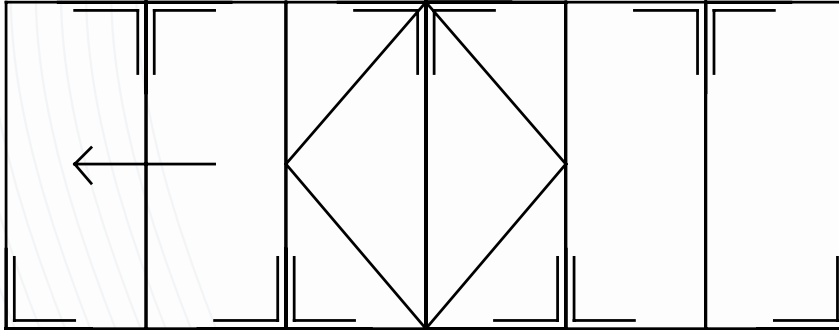

Installing the Doors

D. Glazing and Toe & Heeling

